

**Address : 16 Moo2 Tambon Phimpha Bang-Pakong District Chachoengsao 24180**

**Telephone : 038-989-333 ( Auto ) Fax : 038-989-500-503**

**E-mail : [info@q-power.co.th](mailto:info@q-power.co.th)**

**Web site: [www.q-power.co.th](http://www.q-power.co.th)**





Power Management



Main Distribution Board (MDB)

We produce and sell high quality electrical cabinets in various purposes of uses and sizes, coverth...

Q-Power Engineering Co., Ltd. is the best electrical cabinet manufacturer. We produce Electrical Equipment cabinet, Switchboard cabinet, Control Cabinet, High-Voltage Control cabinet for industries, Infrastructure and Building use. Our high technology machines team up with our high profile experts in engineering system; we are fit to generate the best quality products with international standard within reasonable cost.

For Q-Power Engineering Co., Ltd., our customer's satisfaction is our pride, which motivates us to invent the best quality, easy to operate and most importantly, safe inventions. On top of that, we aim to increase the value of our customers' products and noticeable development of our customers' business.



## Product & Engineering Solutions

<b>POWER</b>	<b>AUTOMATION</b>	<b>PRODUCT</b>	<b>SWITCH BOARD</b>
HV AND TRANSFORMER	PLC	SIEMENS	MDB PANEL
INSTALL MDB, MCC	HMI		MEDIUM VOLT PANEL
RACE WAY	SCADA		CONTROL PANEL
LIGHTING SYSTEM	ENERGY MANAGEMENT		
LIGHTING & GROUNDING	VSD & SOFT START		
FIRE ALARM			



Buildings are changing

Siemens Building Products enable the change

**SIEMENS**

*Ingenuity for Life*

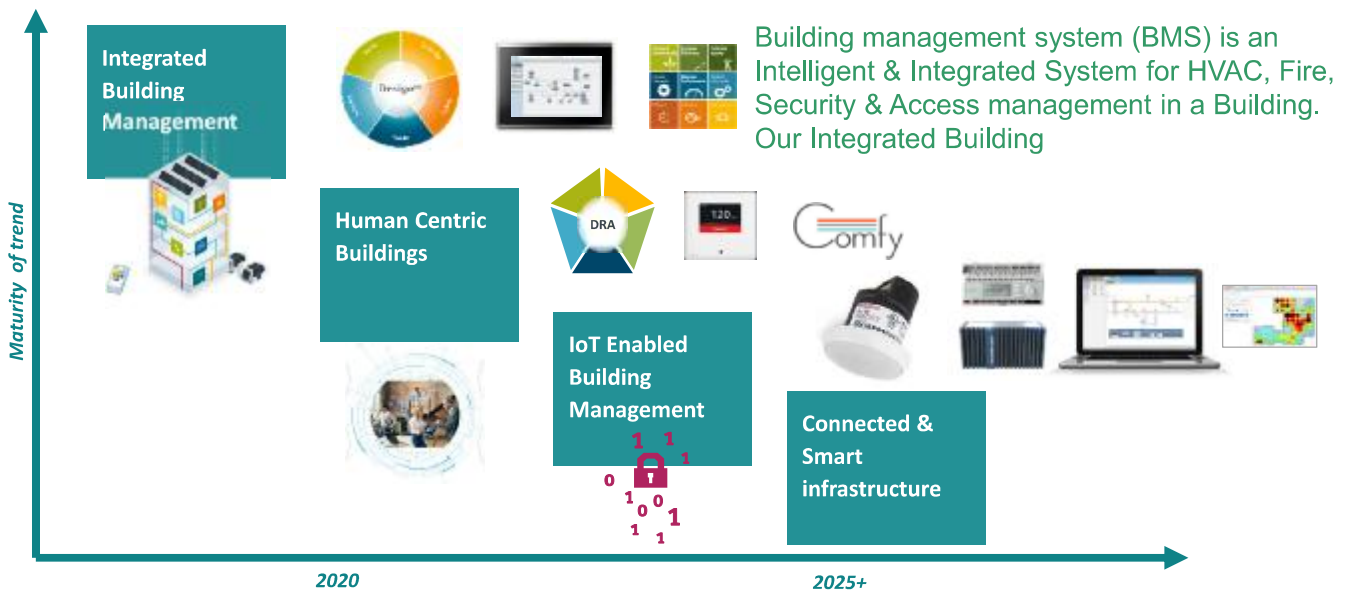

Automation Solutions are designed to simplify the management and protection of industrial, commercial and residential buildings. Our solutions answer to raising emphasis to produce green facilities. Your buildings can not only achieve certification, but also perform at high levels with operational cost savings to property owners and managers. We implement solutions for existing buildings, as well as, newly developments.

## Organization Chart



# Project References



# Safety Policy

- Safety Training.
- Safety Talk on the job.
- Safety officer
- Safety Equipment.
- In delivering safety talks, objective is to help workers **RECOGNIZE** and **CONTROL** hazards in the workplace.



! ? ! ? ! ?  
**SEMINARS**



**SIEMENS**



**CONSUMER UNIT**

**SAFETY SWITCH**

**SIEMENS**



**FACTORY OVER VIEW**





**FINISH**



**PAINTING**



**WIRING**



POWER

MDB, MCC

**Customer : Double A Ethanol Co.,Ltd**

**Project Name : Wet cake (MCC panel)**

- Design MDB and MCC panel for machine
- Test run and Commissioning



**Customer : Double A Ethanol Co.,Ltd**

**Project Name : Wet cake (MCC panel)**



**Customer : Double A Ethanol Co.,Ltd**

**Project Name : Debrieker 690VAC**





Customer : Double A Ethanol Co.,Ltd  
Project Name : โรงกรองน้ำ TYPE TEST



Q-POWER ENGINEERING CO., LTD.



Customer : Double A Ethanol Co.,Ltd  
Project Name : โรงกรองน้ำ 3B TYPE TEST



Q-POWER ENGINEERING CO., LTD.



Customer : Double A Ethanol Co.,Ltd

3B TYPE TEST



PROJECT : MCC MACHINE PANEL



**PROJECT : BULK FILL**



**PROJECT : 6 MWe BANGSAWAN GREEN BIOMASS FIRED POWER PLANT**



**PROJECT : OSCAR SAVE THE WOLD 1 & 2**



**PROJECT : 6 MWe BANGSAWAN GREEN BIOMASS FIRED POWER PLANT**



**PROJECT : SCREENING PLANT**



**Project : SCRAB PANEL**



PROJECT : TMTGW-MOD.SCRAP HOUSE#1\_

**TOYOTA**



Project Name : โรงไฟฟ้าสระบุรี

















**HITACHI**  
Inspire the Next  
Hitachi Automotive Systems





Project Name : Modify MDB INDEX @ ขอนแก่น



Project Name : Modify MDB INDEX @ อุดรธานี



Project Name : Protection systems for solar roof



**PM Inspection of MCC**



**PM Protection relay and function test**



**Inspection Service ACB 690V / VCB 6.6kV**



**Project Name : PM Fire Protection and Fire alarm System**



**Project Name : Preventive maintenance Generator**







**The Future of Buildings**  
Siemens BP

Siemens BP  
THE FUTURE OF BUILDINGS  
**Smart Buildings**



**Project Name : C-BUS & LIGHTING CONTROL SYSTEM**

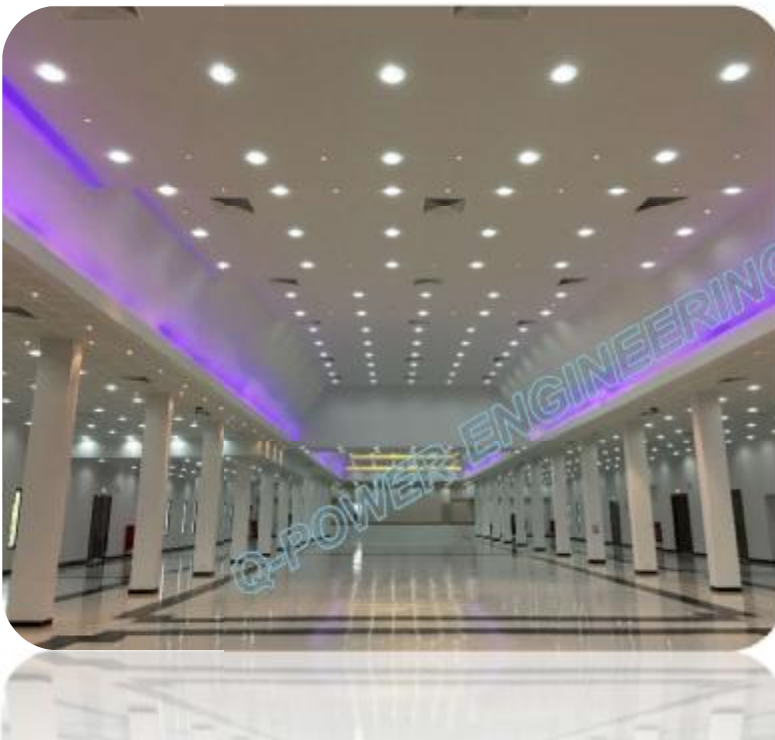

**Project Name : Two wire remote system**



**Project Name : PM BILLING**  
**Customer : The MALL KORAT**



**REPLACE NEW KILOWATT HOUR MEETR**

